

# Glassfibre Flagstaffs

## Rotating Arm

### ASSEMBLY INSTRUCTIONS

October 2018 v5

**PLEASE CHECK THAT THE DIRECTION THE HINGE IS SET IN, LEAVES ENOUGH ALLOWANCE FOR THE FLAGSTAFF THAT IS TO BE INSTALLED**

1. Check the contents. Assemble the hinging plate onto the 3 foundation bolts with the flagstaff hinging lugs uppermost and lock into position with the 3 flat nuts as supplied. (See Fig 1)
2. Connect the 3 long nuts as shown. (See Fig 2). Place the flagstaff locking ring over the long nut next to the flagstaff hinge lug as shown (See Fig 3)
3. To ensure that the foundation bolts remain parallel to one another during the concreting, lock the top template plate into position using the 3 set screws and anti vibration washers as shown. (See Fig 4)
4. Concrete the foundation assembly into position using the foundation size in the chart on page 3. Try to ensure that the ground foundation is as level as possible.
5. When the concrete has set, remove the set screws, template and locking ring.
6. Remove the bolt from the Rotating arm joint, fit to the top of the pole. (See Fig 1). (If tight, it may require gently taping with a hammer).
7. Using a 7mm drill bit, drill the pole through the two holes in the Rotating arm joint, through the pole to the other side. (See Fig 2)
8. Insert the bolt with a washer and then a washer and nut on the other side. (See Fig 3) Tighten until the bolt is through the nylock. ***(The unit can be used without bolting but we advise for safety reasons to do this, if you choose not to bolt the joint on then all liability is yours in the event of the unit becoming detached from the pole in windy conditions.)***
9. Assemble the weight ensuring that it is locked into position as per the instructions, pass it over the rotating joint with the clip towards the top. (See Fig 4)
10. Screw on the onion finial. **KEEP FINIAL RAISED OFF THE GROUND TO AVOID DAMAGING IT**

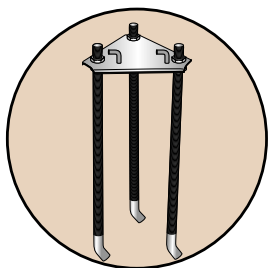


Fig 1,

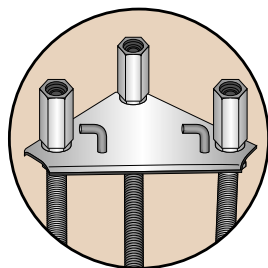


Fig 2,

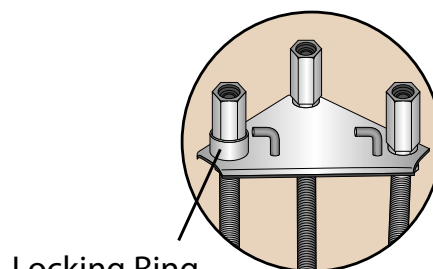


Fig 3,

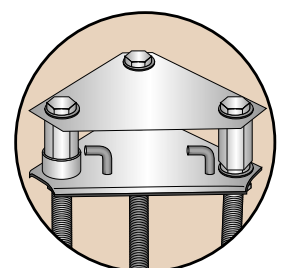


Fig 4,

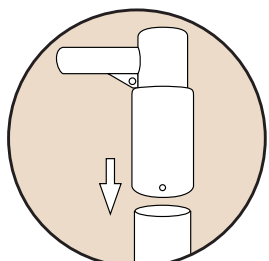


Fig 5,

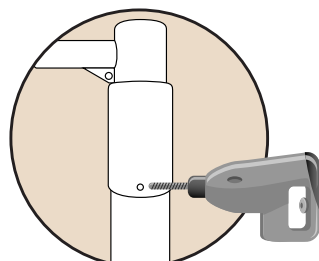


Fig 6,

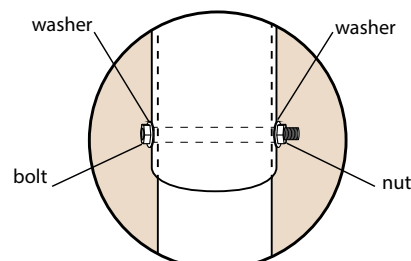


Fig 7,

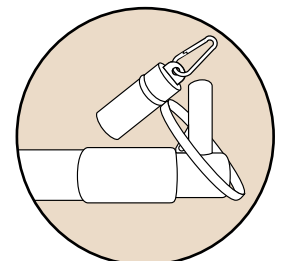


Fig 8,

# Glassfibre Flagstaffs

## Rotating Arm

### ASSEMBLY INSTRUCTIONS

October 2018 v5

11. Clip the arm into place, (See Fig 9). Slide the top sleeve of the flag up the arm, (See Fig 10), and attach the metal clip in the corner of the Rotating arm joint to the top eyelet on the flag. (See Fig 11)
12. Take the cable ties, pass through the additional eyelets on the flag and around the pole, do not over tighten. Clip the weight to the bottom of the flag. (See Fig 12)
13. Assemble the flagstaff onto the lugs, place the locking ring back over the long nut next to the hinging lug. (See Fig 13)

14. Raise the flagstaff, insert and tighten the set screws and anti-vibration washers. (See Fig 14)

***IT IS RECOMMENDED THAT AT LEAST TWO PEOPLE ARE INVOLVED IN RAISING THE FLAGSTAFF***

15. Check the flagstaff is upright with a spirit level. Adjustments can be made by loosening the set screws and adjusting the long nut to bring the flagstaff perpendicular. (See Fig 15) Once satisfied, tighten the three flat nuts back up against the baseplate.

16. Tighten the set screws whilst preventing the long nut from rotating. (See Fig 16)

***IS IS RECOMMENDED THAT ALL NUTS SHOULD BE CHECKED ON A REGULAR BASIS, TO ENSURE THAT THEY ARE FULLY TIGHTENED HOME.***

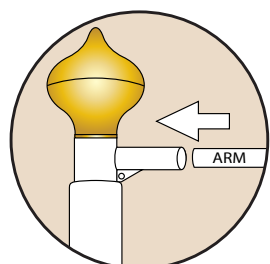


Fig 9

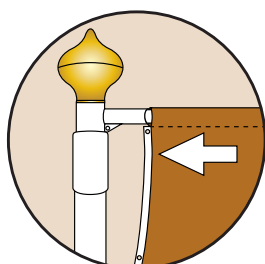


Fig 10

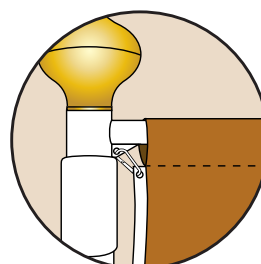


Fig 11

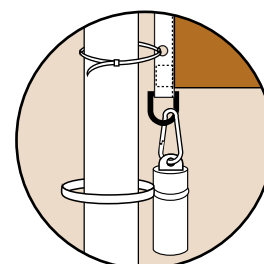


Fig 12

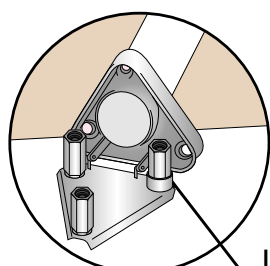


Fig 13,

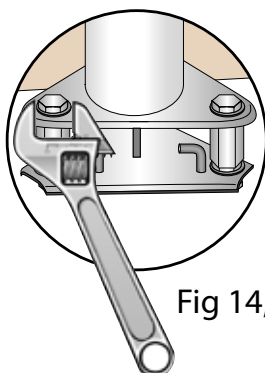
Locking  
Ring

Fig 14,

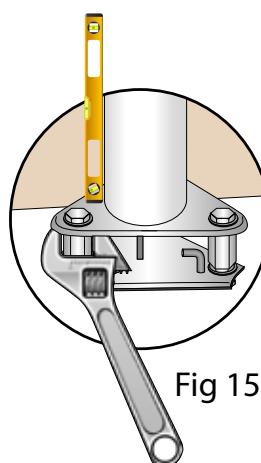


Fig 15,

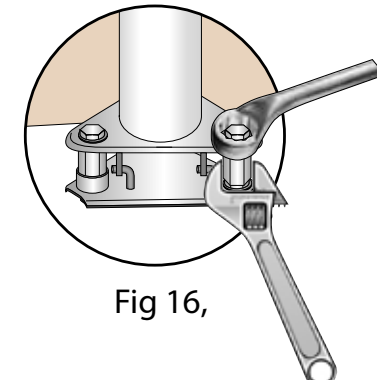


Fig 16,

## WARNINGS

**BEFORE INSTALLATION, CHECK FOR UNDERGROUND SERVICES**

**Re-Usable Ties must never be over tightened**

**Do not fly flag when wind speed exceeds Force 7 (32mph)**

**It remains the responsibility of the user to establish the suitability of the product /s for the use/s to which they are put**

# Glassfibre Flagstaffs

## Rotating Arm

### ASSEMBLY INSTRUCTIONS

October 2018 v5

3 Foundation Bolts	1 Onion Finial
3 Flat Nuts	1 Rotating arm joint
3 Long Nuts	1 Metal Clip
3 Pairs of Anti-Vibration Washers	1 Arm (120cm long)
3 Set Screws	1 Weight
1 Hinging Plate for Flagstaff	Cable Ties
1 Locking Ring for Flagstaff	1 Bolt
1 Top Template plate	2 washer
	1 Nylock Nut

### CONTENTS

### Glassfibre Flagstaff Specifications

Flagstaff Height - A	6m	8m	10m	12m
Butt Diameter	115mm	115mm	135mm	135mm
Top Diameter	65mm	65mm	65mm	65mm
Weight internal diameter	150mm	150mm	150mm	150mm
Packed weight inc. Baseplate	14kg	16kg	28kg	34kg
Weight of Ground Plate inc. Bolts/Nuts/Washers	6kg	6kg	6kg	6kg
Additional Weight of Internal Halyard System	4kg	4kg	4kg	4kg
Baseplate Dimension - B	200mm	200mm	200mm	200mm
Hole Centres - C	168mm	168mm	168mm	168mm
Ground Plate Dimension - D	200mm	200mm	200mm	200mm
Hole Centres - E	168mm	168mm	168mm	168mm
Bolt ( M20 ) Length - F	600mm	600mm	600mm	600mm
Foundation Depth*	800mm	1000mm	1000mm	1000mm
Foundation Square*	500mm	500mm	650mm	650mm
Arm length	1.2m	1.2m	1.2m	1.2m
Arm Outside diameter	22mm	22mm	22mm	22mm
Arm Inside diameter	18mm	18mm </td <td>18mm</td> <td>18mm</td>	18mm	18mm
Wall thickness	2.25mm	2.25mm	2.25mm	2.25mm
Packed size	1.2x0.1x0.3m	1.2x0.1x0.3m	1.2x0.1x0.3m	1.2x0.1x0.3m
Weight	3kg	3kg	3kg	3kg
Maximum Flag Size	1.2m x 4m	1.2m x 4.5m	1.2m x 5.5m	1.2m x 6m
Maximum Flag Size (double thickness)	1m x 4m	1m x 4m	1m x 4m	1m x 4m

\*These are suggested dimensions only, actual measurements will depend on ground conditions

