

PRIOR TO INSTALLING WALL MOUNTED FLAGSTAFFS, WE RECOMMEND THAT YOU SEEK ADVICE REGARDING THE SUITABILITY OF THE WALL AND THE BEST TYPE OF FIXINGS FROM A PROFESSIONAL SOURCE

ENSURE THAT YOUR ARM CAN ROTATE FREELY OF ANY OBSTACLES

1. Check contents. Position bottom bracket ensuring that it is vertical, drill holes and bolt to the wall (see Fig 1).
2. Centralise the top bracket vertically above the bottom bracket with the specified distance between the holes as shown the chart on page 2. Drill and fix into position (see Fig 2).
3. Place the ground socket into the brackets, ensuring it sits in the bottom of the bottom bracket properly and level with the TOP EDGE of the top bracket (see Fig 3).
4. Place the weight over the main pole. (see fig 4)
5. Ensure that the PTFE sheet lines the inside of the joint casing and the washer is in the bottom before connecting the curved tube with the joint to the main pole. (see fig 5)
6. Slide the sleeve of the flag over the curved tube and down onto the main pole. (see fig 6)
7. Attach the weight onto the rope loop at the bottom of the flag. (see fig 7)
8. Mount the pole into the ground socket (see Fig 8).

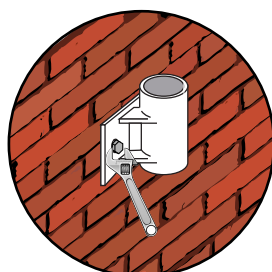

Fig 1.

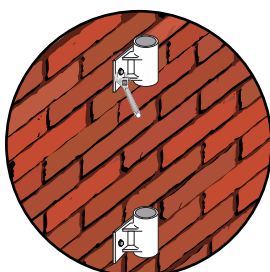

Fig 2.

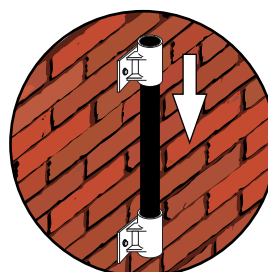

Fig 3.

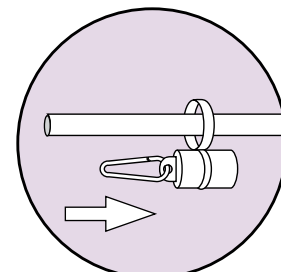

Fig 4.

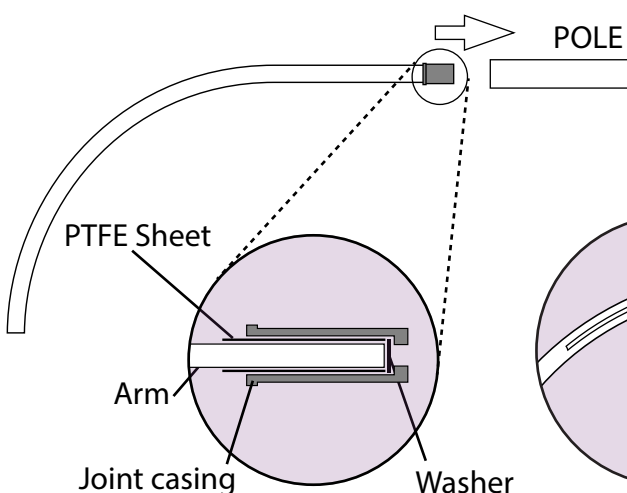

Fig 5.

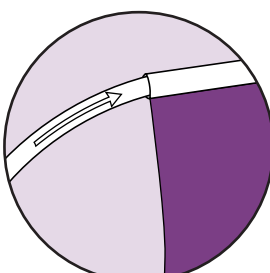

Fig 6.

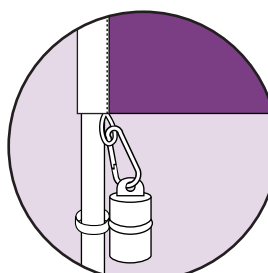

Fig 7.

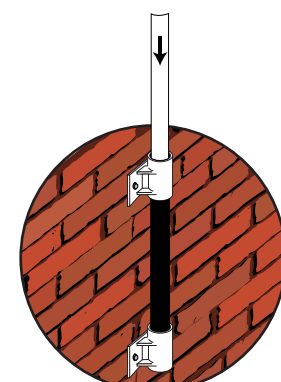

Fig 8.

Main Ali Pole

1.5m Curved Arm and joint

Weight

Wedge

Top Bracket

Bottom Bracket

Ground Socket

BOLTS NOT INCLUDED

CONTENTS

Feather Pole Specifications

Pole Size	4.8m	5.8m
Length of curved top section	0.8m	0.8m
Inside dia of curved section	25.63mm	25.63mm
Outside dia of curved section	28.57mm	28.57mm
Length of main section	4m	5m
Inside dia of main section	40.39mm	40.39mm
Outside dia of main section	44.45mm	44.45mm
Wall thickness	2mm	2mm
Pole Weight	4kg	5kg
Ground socket internal diameter	46.5mm	46.5mm
Ground socket external diameter	53.5mm	53.5mm
Length of ground socket	600mm	600mm
Weight	300g	300g
Bracket plate size	200mm x 100mm	200mm x 100mm
Bracket internal diameter	55mm	55mm
Bolt hole diameter	14mm	14mm
Distance between top and bottom bracket (centre of hole to hole)	520mm	520mm
Total weight of kit and pole	8.43kg	9.43kg
Max flag size	80cm x 320cm	80cm x 420cm

Curved Arm

Main Ali Section

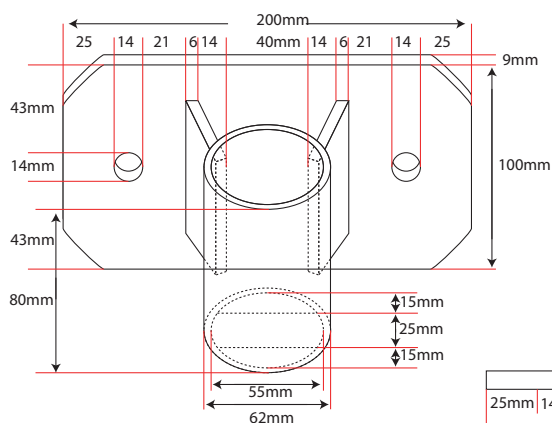

PRIOR TO INSTALLING WALL MOUNTED FLAGSTAFFS, WE RECOMMEND THAT YOU SEEK ADVICE REGARDING THE SUITABILITY OF THE WALL AND THE BEST TYPE OF FIXINGS FROM A PROFESSIONAL SOURCE

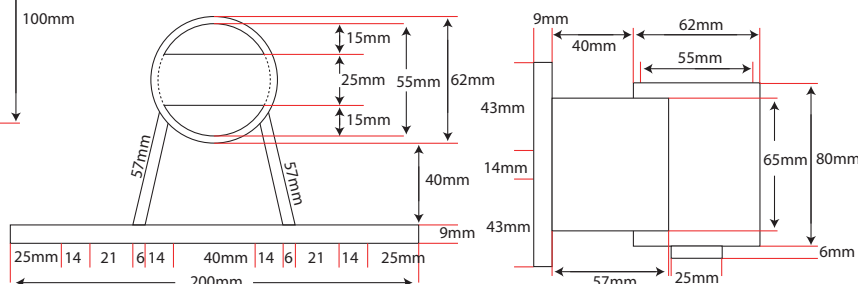

WARNINGS

Do not fly flag when wind speed exceeds Force 7 (32mph)

It remains the responsibility of the user to establish the suitability of the product /s for the use/s to which they are put